

SECTION II

TM 9-2320-366-24P-1

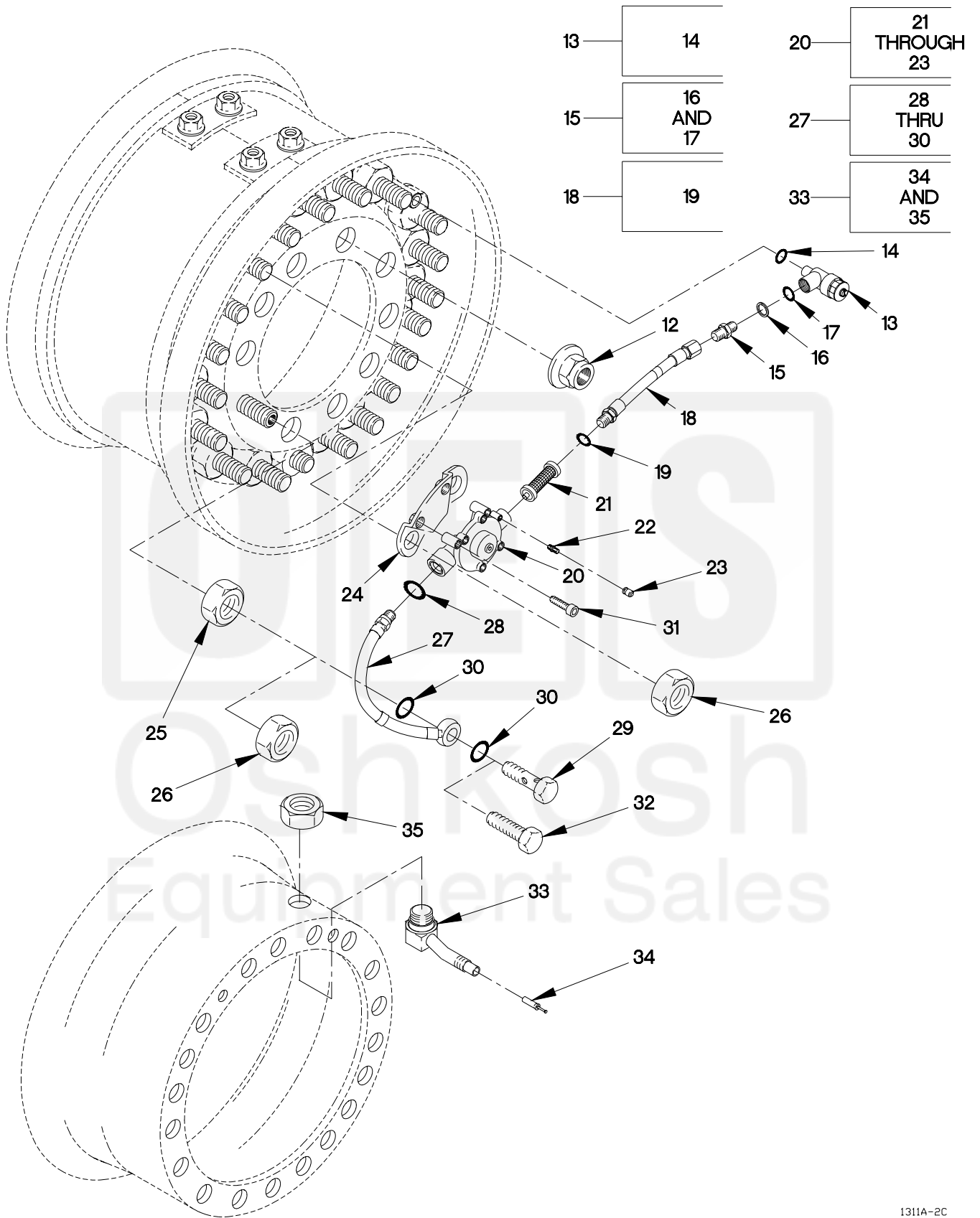

1311A-2C

FIGURE 207. WHEEL ASSEMBLY AND CTIS VALVE (SHEET 2 OF 2)

SECTION II

TM 9-2320-366-24P-1

(1) ITEM NO	(2) SMR CODE	(3) CAGEC	(4) PART NUMBER	(5) DESCRIPTION AND USABLE ON CODE (UOC)	(6) QTY
23	PAOZZ	81381	673719	.CAP.....	1
24	PAOZZ	1MVZ1	673222	BRACKET,MOUNTING.....	1
25	PAOZZ	19207	10938444-1	NUT,PLAIN,SINGLE BA 1 1/8-16 LEFT HAND.....	3
25	PAOZZ	19207	10938444-2	NUT,PLAIN,SINGLE BA 1 1/8-16 RIGHT HAND.....	3
26	PAOZZ	96906	MS35691-53	NUT,PLAIN,HEXAGON 5/8-UNF (FOR SPARE TIRE).....	1
27	PAOZZ	1MVZ1	673997	HOSE ASSEMBLY,NONME.....	1
28	PAOZZ	1MVZ1	673269	.O-RING.....	1
29	PAOZZ	1MVZ1	673998	.BOLT,FLUID PASSAGE.....	1
30	PAOZZ	1MVZ1	673999	.SEAL,NONMETALLIC RO.....	2
31	PAOZZ	19207	12414475-224	SCREW,CAP,SOCKET HE M8 X 1.25 X 30.	2
32	PAOZZ	80204	B1821BH063F150N	SCREW,CAP,HEXAGON H 5/8-18 X 1 1/2 (SPARE TIRE ONLY).....	1
33	PAOZZ	17875	VS-1090-ALT	VALVE,PNEUMATIC TIR.....	1
34	PAOZZ	81348	TYV/CL2/TR C1	.VALVE CORE.....	1
35	PAOZZ	17875	265	.NUT,PLAIN,HEXAGON 11/16-16.....	1

END OF FIGURE

